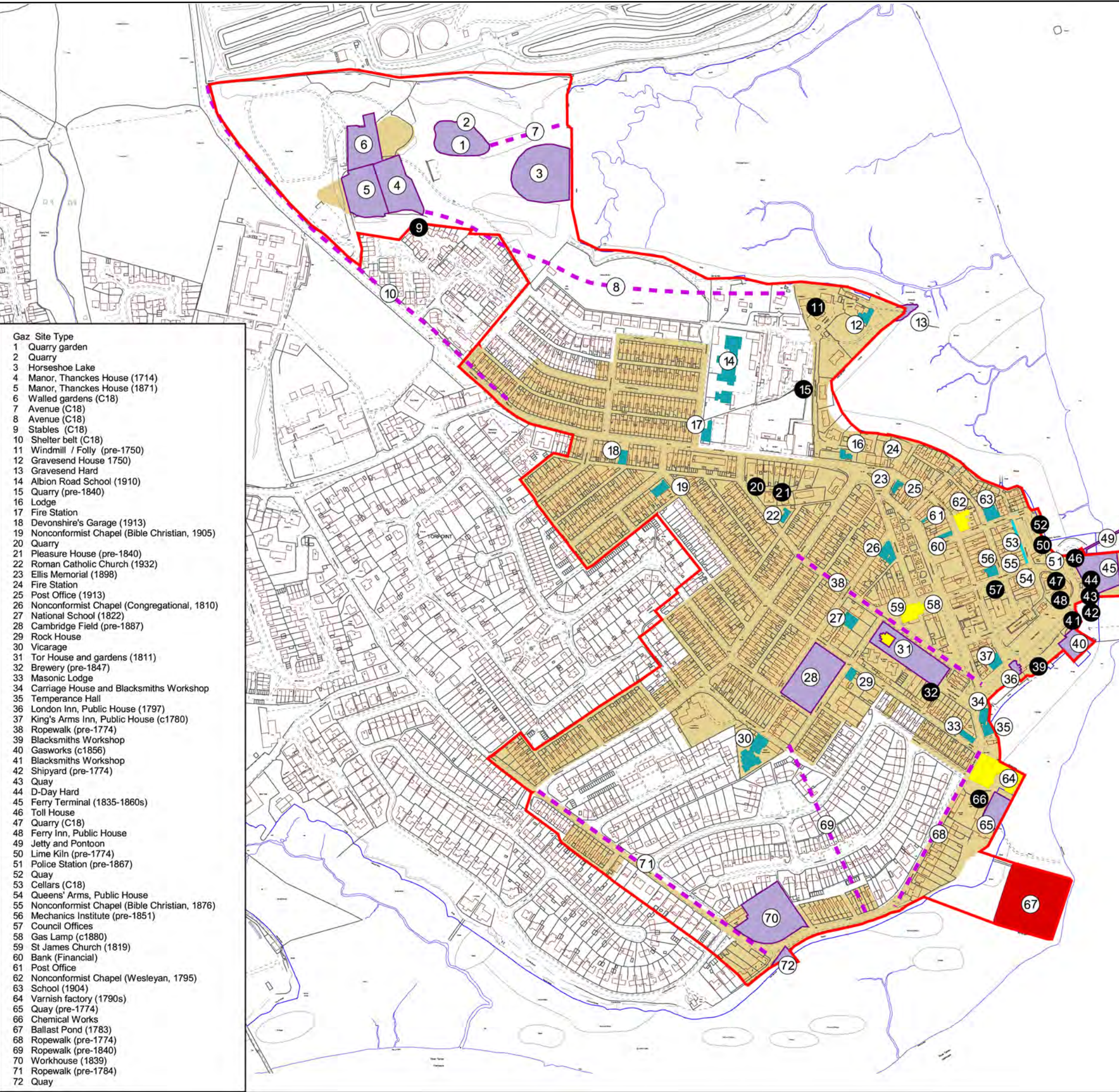

Figure 6. Archaeological potential

**Key**

-  Primary study area (1907 urban extent)
-  Archaeological investigations (the whole site is covered by the Plymouth Forts study)
-  Historic Site / Listed Building (historic extent known)
-  Archaeological / Historic Site (historic extent known)
-  Archaeological / Historic Site (approximate location)
-  c.1907 urban extent

- Gaz Site Type**
- 1 Quarry garden
  - 2 Quarry
  - 3 Horseshoe Lake
  - 4 Manor, Thanckes House (1714)
  - 5 Manor, Thanckes House (1871)
  - 6 Walled gardens (C18)
  - 7 Avenue (C18)
  - 8 Avenue (C18)
  - 9 Stables (C18)
  - 10 Shelter belt (C18)
  - 11 Windmill / Folly (pre-1750)
  - 12 Gravesend House 1750)
  - 13 Gravesend Hard
  - 14 Albion Road School (1910)
  - 15 Quarry (pre-1840)
  - 16 Lodge
  - 17 Fire Station
  - 18 Devonshire's Garage (1913)
  - 19 Nonconformist Chapel (Bible Christian, 1905)
  - 20 Quarry
  - 21 Pleasure House (pre-1840)
  - 22 Roman Catholic Church (1932)
  - 23 Ellis Memorial (1898)
  - 24 Fire Station
  - 25 Post Office (1913)
  - 26 Nonconformist Chapel (Congregational, 1810)
  - 27 National School (1822)
  - 28 Cambridge Field (pre-1887)
  - 29 Rock House
  - 30 Vicarage
  - 31 Tor House and gardens (1811)
  - 32 Brewery (pre-1847)
  - 33 Masonic Lodge
  - 34 Carriage House and Blacksmiths Workshop
  - 35 Temperance Hall
  - 36 London Inn, Public House (1797)
  - 37 King's Arms Inn, Public House (c1780)
  - 38 Ropewalk (pre-1774)
  - 39 Blacksmiths Workshop
  - 40 Gasworks (c1856)
  - 41 Blacksmiths Workshop
  - 42 Shipyard (pre-1774)
  - 43 Quay
  - 44 D-Day Hard
  - 45 Ferry Terminal (1835-1860s)
  - 46 Toll House
  - 47 Quarry (C18)
  - 48 Ferry Inn, Public House
  - 49 Jetty and Pontoon
  - 50 Lime Kiln (pre-1774)
  - 51 Police Station (pre-1867)
  - 52 Quay
  - 53 Cellars (C18)
  - 54 Queens' Arms, Public House
  - 55 Nonconformist Chapel (Bible Christian, 1876)
  - 56 Mechanics Institute (pre-1851)
  - 57 Council Offices
  - 58 Gas Lamp (c1880)
  - 59 St James Church (1819)
  - 60 Bank (Financial)
  - 61 Post Office
  - 62 Nonconformist Chapel (Wesleyan, 1795)
  - 63 School (1904)
  - 64 Varnish factory (1790s)
  - 65 Quay (pre-1774)
  - 66 Chemical Works
  - 67 Ballast Pond (1783)
  - 68 Ropewalk (pre-1774)
  - 69 Ropewalk (pre-1840)
  - 70 Workhouse (1839)
  - 71 Ropewalk (pre-1784)
  - 72 Quay



N

metres

0 50 100

CCC licence No. 10019590. All material copyright (c) Cornwall County Council 2005.

Historic Environment Service  
Environment and Heritage  
Cornwall County Council  
(01872) 323603  
cau@cornwall.gov.uk